

Component Nomenclature –

Scrapers –

SAE J728 JUL84

SAE Standard
Completely Revised July 1984

S. A. E.
LIBRARY

THIS IS A PREPRINT WHICH IS
SUBJECT TO REVISIONS AND
CORRECTIONS. THE FINAL
VERSION WILL APPEAR IN THE
1986 EDITION OF THE SAE
HANDBOOK.

SAE *The Engineering
Resource For
Advancing Mobility*

PREPRINT

SAENORM.COM : Click to view the full PDF of j728_198407

Copyright 1984 Society of Automotive Engineers, Inc.

This report is published by SAE to advance the state of technical and engineering sciences. The use of this report is entirely voluntary, and its applicability and suitability for any particular use, including any patent infringement arising therefrom, is the sole responsibility of the user.

PRINTED IN U.S.A.

COMPONENT NOMENCLATURE—SCRAPERS— SAE J728 JUL84

SAE Standard

Report of the Construction and Industrial Machinery Technical Committee, approved May 1959, completely revised by the Off-Road Machinery Technical Committee, July 1984. Rationale statement available.

Purpose—This SAE Standard provides names of major components peculiar to the scraper portion of Tractor-Scrapers. Reference SAE J1057 JUN81. Illustrations of components are not intended to be exactly descriptive of any particular machine.

Push-Pull or Dual Load—Mechanism which allows one tractor-scraper to assist in loading another tractor-scraper by pushing or pulling through engagement devices which usually include push plates, a hook, and a bail.

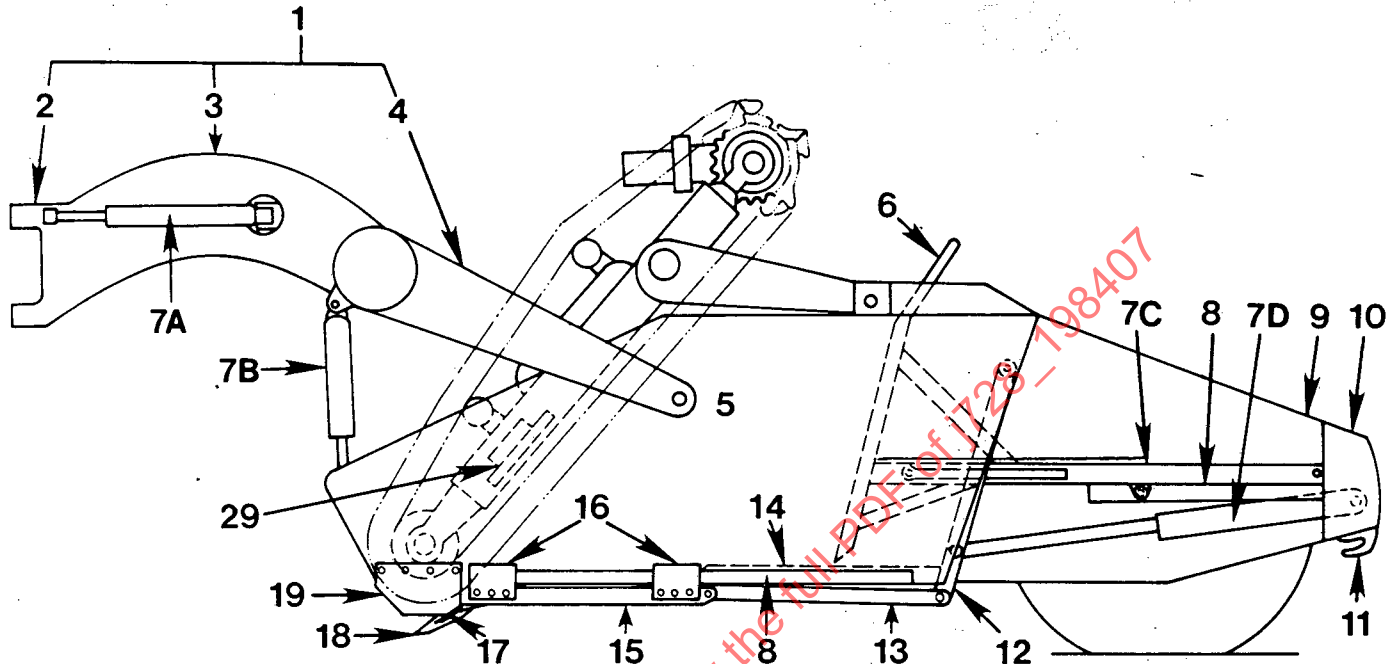

FIG. 1

- | | | |
|------------------------|----------------------------|----------------------------------|
| 1. FRAME, DRAFT | 9. FRAME, REAR | 20. ELEVATOR |
| 2. HOUSING, KINGPIN | 10. BUMPER | 21. IDLER, LOWER |
| 3. GOOSENECK | 11. HOOK, TOW | 22. FRAME, ELEVATOR |
| 4. ARM, DRAFT | 12. LEVER, FLOOR | 23. CHAIN |
| 5. BOWL | 13. LINK, FLOOR | 24. IDLER, CHAIN SUPPORT/TENSION |
| 6. EJECTOR | 14. FLOOR, FIXED | 25. DRIVE, ELEVATOR |
| 7A. CYLINDER, STEERING | 15. FLOOR, MOVABLE | 26. FLIGHT |
| 7B. CYLINDER, BOWL | 16. SLIDE (ROLLERS), FLOOR | 27. SPROCKET, CHAIN |
| 7C. CYLINDER, EJECTOR | 17. CUTTING EDGE | 28. ARM, ELEVATOR |
| 7D. CYLINDER, FLOOR | 18. TOOTH | 29. SUPPORT ELEVATOR |
| 8. RAIL | 19. BIT, SIDE | 30. TRUCK, FRONT |

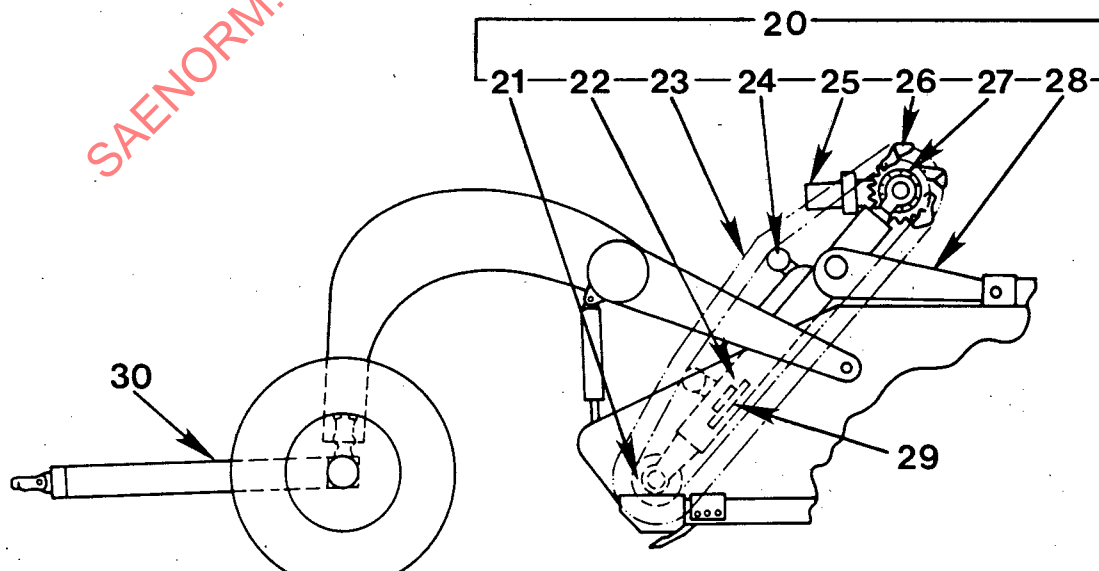

FIG. 2